



TYPICAL MOTOR PERFORMANCE DATA

Model: MNET00606A2TBR

Serie: NEMA Elite

Issued Date	11/14/2022	Doc. #	390-R0
Issued By	LD	Issued Rev	0

HP	kW	Pole	FL RPM	Frame	Voltage	Hz	Phase	FL Amps
60.00	45.00	6	1180	404T	230/460	60	3	146/73
Enclosure	IP	Ins. Class	S.F.	Duty	Nom. Eff.	Nema Design	kVA Code	Ambient Temp. (°C)
TEFC	55	F (*)	1.15	CONT	94.5	B	F	40 C

* Inverter Duty

Load	HP	kW	Amperes	Efficiency (%)	Power Factor (%)
Full Load	60.00	45.00	72.0	94.5	81.9
¾ Load	45.00	33.60	57.0	94.2	78.3
½ Load	30.00	22.40	43.0	92.8	69.6
¼ Load	15.00	11.20	33.0	87.6	48.5
No Load			24.1		0.0
Locked Rotor			420.0		30.8

Torque				Rotor Inertia (lb-ft²)
Full Load (lb-ft)	Locked Rotor (% FLT)	Pull Up (% FLT)	Break Down (% FLT)	
267.00	180.0	170.0	230.0	30.94

Safe Stall Time(s)	Sound Pressure dB(A) @ 1M	Bearings*		Approx. Motor Weight (lbs)
Cold / Hot		DE	NDE	
34 / 23	-	6317C3	6313C3	1152

*Bearings are the only recommended spare part(s).

Included Accessories:

All characteristics are average expected values.

Engineering	Doc. Written By	Doc.# / Rev	MNET00606A2TBR
Engr. Date	Doc. Approved By	Doc. Issued	



SPEED TORQUE/CURRENT CURVE

Model: MNET00606A2TBR

Serie: NEMA Elite

Issued Date	11/14/2022	Doc. #	390-R0
Issued By	LD	Issued Rev	0

HP	kW	Pole	FL RPM	Frame	Voltage	Hz	Phase	FL Amps
60.00	45.00	6	1180	404T	230/460	60	3	146/73
Enclosure	IP	Ins. Class	S.F.	Duty	Nom. Eff.	Nema Design	kVA Code	Ambient Temp. (°C)
TEFC	55	F (*)	1.15	CONT	94.5	B	F	40 C
Locked Rotor Amps	Rotor Inertia (lb-ft ²)	Torque						
		Full Load (lb-ft)	Locked Rotor (%)	Pull Up (%)	Break Down (%)			
420.0	30.94	267	180.0	170.0	230.0			

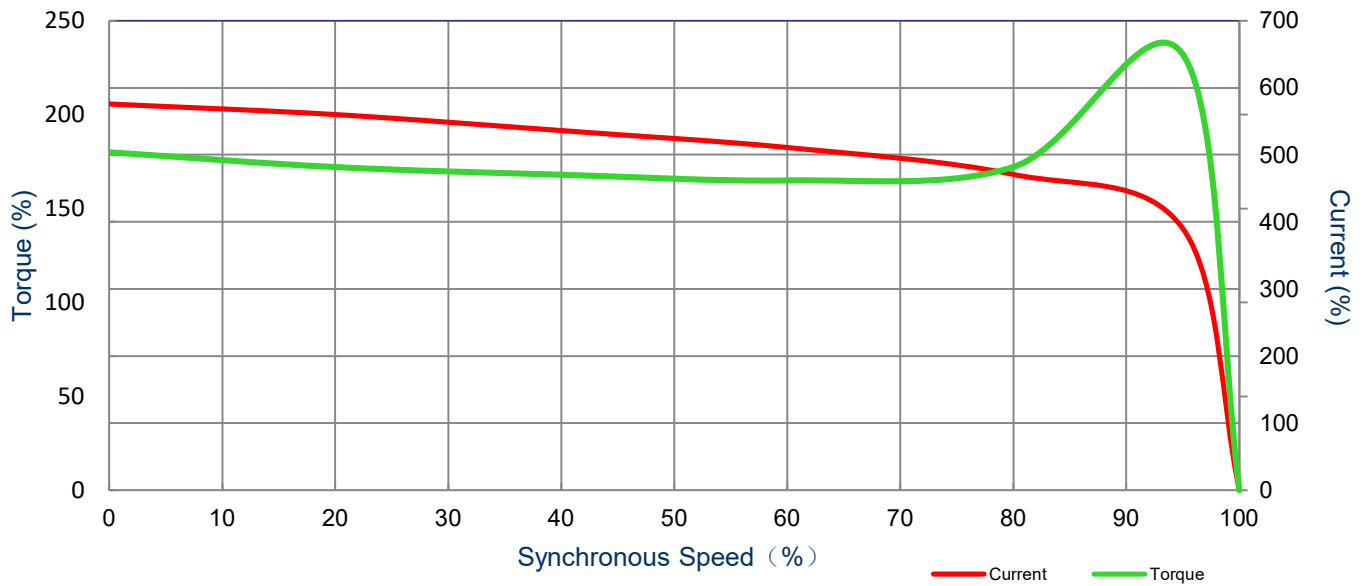

All characteristics are average expected values.

Engineering		Doc. Written By		Doc.# / Rev	MNET00606A2TBR
Engr. Date		Doc. Approved By		Doc. Issued	



TYPICAL MOTOR PERFORMANCE DATA

Model: MNET00606A2TBR

Serie: NEMA Elite

Issued Date	11/14/2022	Doc. #	382-R0
Issued By	LD	Issued Rev	0

HP	kW	Pole	FL RPM	Frame	Voltage	Hz	Phase	FL Amps
60.00	45.00	4	1470	404T	190/380	50	3	168/84
Enclosure	IP	Ins. Class	S.F.	Duty	Nom. Eff.	Nema Design	kVA Code	Ambient Temp. (°C)
TEFC	55	F (*)	1.2	CONT	94.1	B	F	40 C

* Inventer Duty

Load	HP	kW	Amperes	Efficiency (%)	Power Factor (%)
Full Load	60.00	45.00	84.0	94.8	86.5
¾ Load	45.00	33.60	63.0	95.5	85.1
½ Load	30.00	22.40	44.0	95.6	80.4
¼ Load	15.00	11.20	29.0	89.1	64.7
No Load			19.3		0
Locked Rotor			515.0		26.3

Torque				Rotor Inertia (lb-ft²)
Full Load (lb-ft)	Locked Rotor (% FLT)	Pull Up (% FLT)	Break Down (% FLT)	
214.00	140.0	125.0	220.0	16.8

Safe Stall Time(s) Cold / Hot	Sound Pressure dB(A) @ 1M	Bearings*		Approx. Motor Weight (lbs)
		DE	NDE	
23 / 9	-	6317C3	6313C3	1152

*Bearings are the only recommended spare part(s).

Included Accessories:

All characteristics are average expected values.

Engineering		Doc. Written By		Doc.# / Rev	MNET00606A2TBR
Engr. Date		Doc. Approved By		Doc. Issued	



SPEED TORQUE/CURRENT CURVE

Model: MNET00606A2TBR

Serie: NEMA Elite

Issued Date	11/14/2022	Doc. #	382-R0
Issued By	LD	Issued Rev	0

HP	kW	Pole	FL RPM	Frame	Voltage	Hz	Phase	FL Amps
60.00	45	4	1470	404T	190/380	50	3	168/84
Enclosure	IP	Ins. Class	S.F.	Duty	Nom. Eff.	Nema Design	kVA Code	Ambient Temp. (°C)
TEFC	55	F (*)	1.2	CONT	94.1	B	F	40 C
Locked Rotor Amps	Rotor Inertia (Kg-m2)	Torque						
		Full Load (lb-ft)	Locked Rotor (%)	Pull Up (%)	Break Down (%)			
515.0	16.8	214	140.0	125.0	220.0			

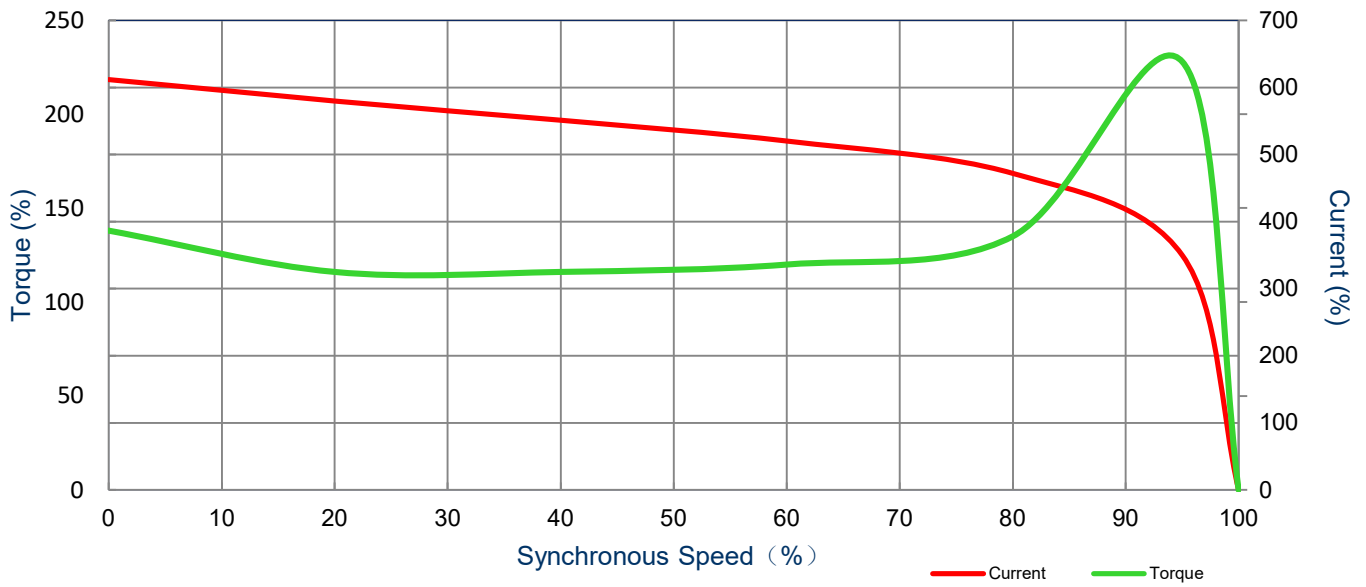

All characteristics are average expected values.

Engineering	Doc. Written By	Doc.# / Rev
Engr. Date	Doc. Approved By	Doc. Issued

MNET00606A2TBR

Issued Date	11/14/2022	Doc. #	390-R0
Issued By	LD	Issued Rev	0

Motor Connection Diagram

Model: MNET00606A2TBR

Serie: NEMA Elite

12 Leads Connection Diagram

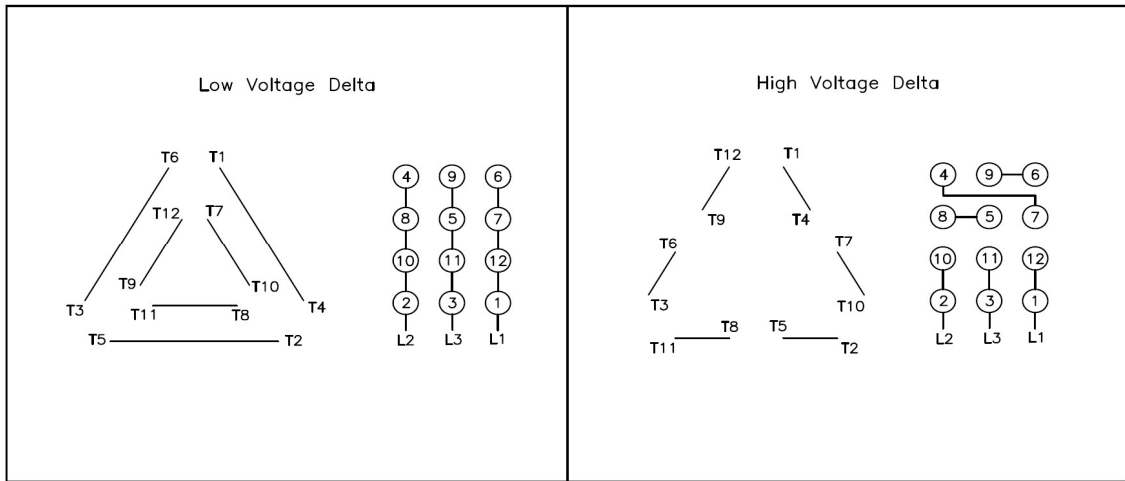

All characteristics are average expected values.

Engineering		Doc. Written By		Doc.# / Rev	MNET00606A2TBR
Engr. Date		Doc. Approved By		Doc. Issued	

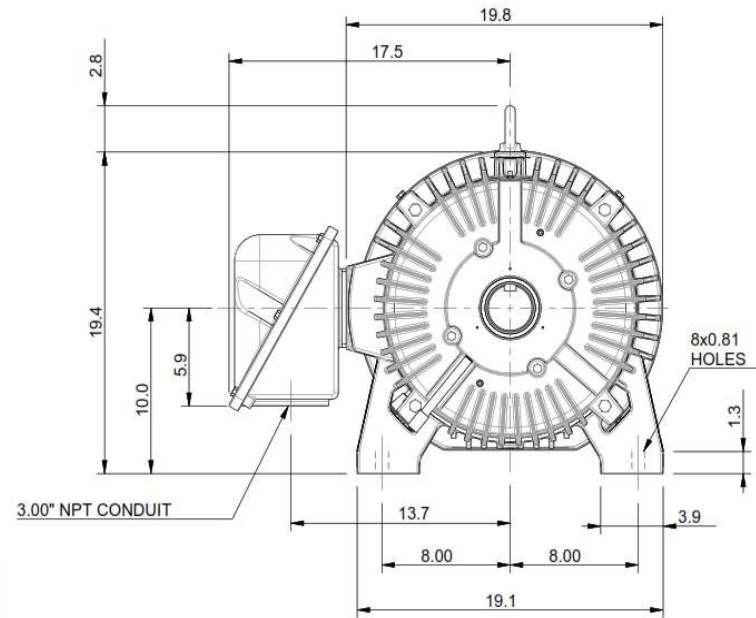
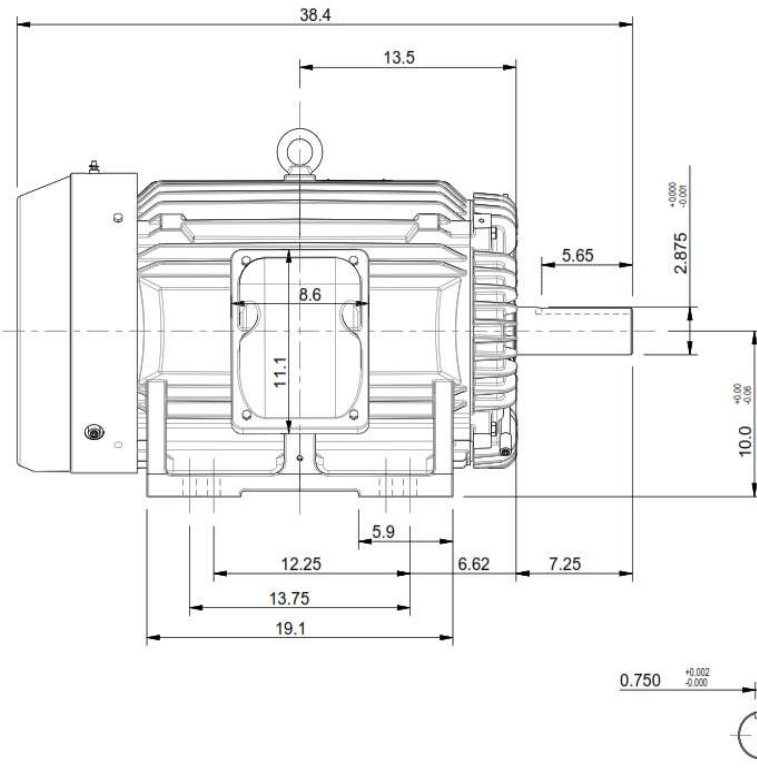

Units: inches		PROPRIETARY INFORMATION We reserve all rights in this document and in the information contained therein. Reproduction, use or disclosure to third parties without express authorization is strictly forbidden. Offenders will be held liable for payment of damages.	Notes:		
ROTATION FROM NDE			1. MAIN CONDUIT BOX MAY BE ROTATED IN 90 DEGREE INCREMENTS		
CCW	CW		2. STANDARD PRODUCT USES BI-DIRECTIONAL FAN. OPPOSITE ROTATION AVAILABLE ONLY BY CONNECTION CHANGE.		
↶	↷				
X					
TASHIDA RESERVES THE RIGHT TO MAKE CHANGES OF TECHNICAL IMPROVEMENT AND THE DATA MAY CHANGE WITHOUT NOTICE				PRELIMINARY	
DO NOT USE FOR CONSTRUCTION, INSTALLATION, OR APPLICATION PURPOSES UNLESS THE DRAWING IS MARKED AS CERTIFIED				X CERTIFIED	
<h1>Tashida</h1>		TOTALLY ENCLOSED FAN COOLED HORIZONTAL FOOT MOUNTED 3 PHASE INDUCTION MOTOR		Drawing #: MNET00606A2TBR	
				Rev. Date: 11/14/2022	Rev. #: 0
		Standard: NEMA	Mount.: F1		
		Frame: 404T - 405T	Per.:	LD	